

Cross Country & Track

These diagrams are provided as a courtesy service of MTP. If you have any question about this diagram, please contact your league office.

For all your field athletic needs, Call Missouri Turf!



Cross Country Finish Chute Assembly

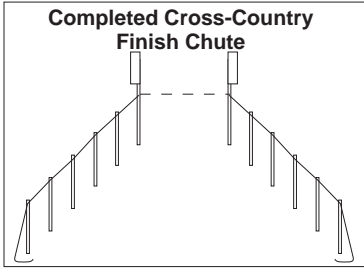

Note: Finish Chute Set #FC-1 includes 120 ft. of Poly Rope. Pennant Lines are available as an option (CC-305).

Side view of 1 side of finish chute

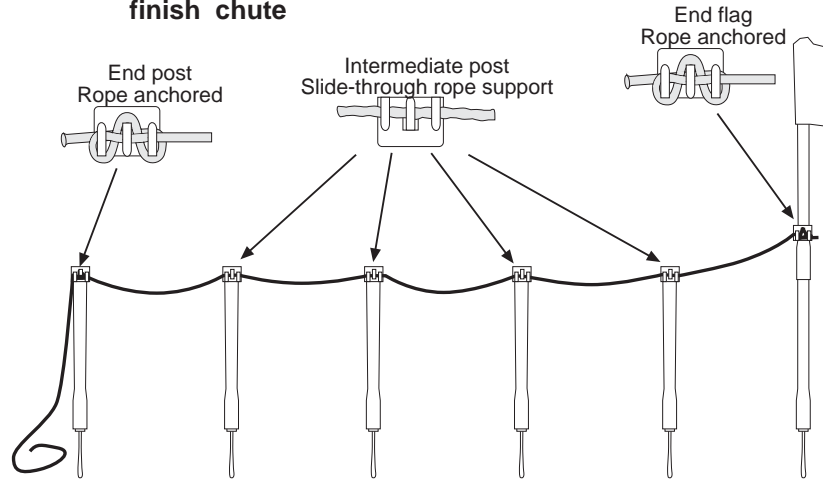

Hide-a-Spike Assembly



Product is shipped with spike inside large end of pole for safety. This is the preferred, safe mode for transport and storage.



Pull spike out of pole when ready to use.

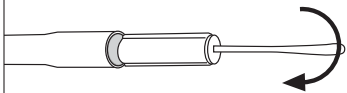

Rotate spike 180° when ready to use.



Insert spike into large end of pole as shown.

Discus/Shot Put/Javelin Sector Flags

1. Slip flag over small end of pole
2. Remove and install safety spike as shown - insert into ground.

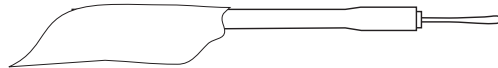

Directional/Milemarker Cross Country Signs

1. Place sign face down on a solid surface.
2. Push elbow into the receptacle on back of sign.
3. Insert bottom pole into top pole. Slide top pole into elbow.
4. Remove and install safety spike as shown - insert into ground.

To change arrow direction simply rotate on elbow.

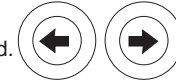

Tall Course Marker Flags

1. Slip flag over small end of top pole
2. Insert bottom pole into large end of top pole.
3. Remove and install safety spike as shown - insert into ground.

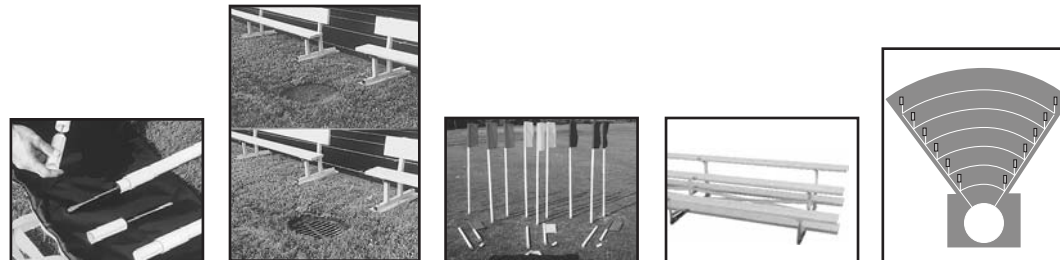

Call us Toll Free
800-426-0774

Missouri turf paint
AND FIELD GRAPHICS

1147 East 63rd Street, Kansas City, MO 64110
www.missouriturfpaint.com